

# CONTROLLING



# CONTENTS

## **ELRUS Controller Packages . . . . .4**

Control Vans

## **Pop-Up Control Towers. . . . .8**

Pop-Up Towers Mounted on Pull Trailers

Stationary Control Towers





## CONTROL TRAILER PACKAGES

Control vans provide a centralized control station designed to improve operating efficiency, create a healthier working environment, and enhance site safety. Originally serving as a shelter for the Genset, power vans/control trailers have now evolved into the centralized control hub for the entire crushing spread.

Modern control trailers play a vital role in optimizing operational efficiency and ensuring a safer, healthier work site for all personnel. ELRUS pioneered the development of the Control Van in the crushing industry and today offers a complete, integrated solution with a Genset, Switchgear, and a 6' x 10' tower—all in one unit.

For operators, the trailer offers a more comfortable working environment, featuring an ergonomic captain's chair, air conditioning, heating, tinted glass, and blinds for added privacy. The control panel includes switches for each component of the crushing spread, and with a 360-degree view of the entire operation, operators have complete control, resulting in improved safety, productivity, and profitability.

# CONTROL VAN

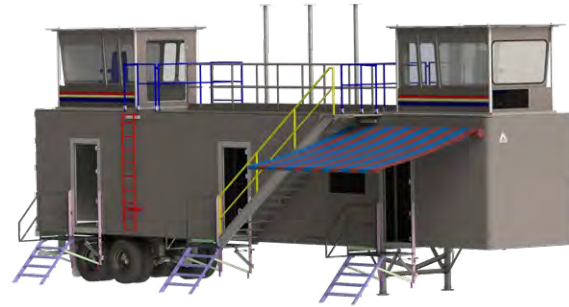

## FEATURES:

- 6' x 10' Control Tower with platform and railings, emergency ladder, stairs from tower to trailer, hydraulic scissor lift, steel side door with locking striker, and crank-down ground-to-trailer stairs with handrails and landing
- 7-ft partitioned generator room with floor grating and a double-walled, 7,774-liter (2,050 U.S. gallon) Envirotank featuring a locking cap and fuel level indicator
- Climate control to ensure operator comfort
- Ample space for control panel, phone, computer controls, and other equipment
- Hydraulic system for easy raising and lowering of the unit for travel or security
- Rear access with a full-glass floor and aluminum floor hatch for safe escape
- Fully wired for lights, air conditioning, heat, and additional accessories



### Optional Trailer Configurations:

Control trailers can be customized to meet specific requirements. With various door, axle, and tower configurations, we can build equipment tailored to your needs.

### Cab Pressurization Unit:

This unit uses its own high-pressure air pump to deliver dual-filtered air into the enclosure, creating positive pressure inside. This ensures that dirt is pushed out of unsealed areas like doors and windows, rather than being drawn into the enclosure.

### Hydraulic Run-on Leveling Legs:

Ideal for control vans with a Genset located at the front of the trailer, accessed via swing-open barn doors.

### Additional Available Options:

- ELRUS 11,340-liter (3,000 U.S. gallon / 2,495 Imp) fuel tank
- Fuel tank drainage pump
- Windshield wipers (installation included) with three switches, three wiper arms, blades, and a power pack
- Self-contained, high-capacity composting toilet: water-free, chemical-free, easy to clean, and easy to winterize
- Vacuflo system for enhanced cleaning and maintenance

### Walk Around Tower Platform:

Allows safe 360-degree access to the tower's exterior for maintenance and other tasks.





## POP-UP CONTROL TOWERS

Pop-Up Control Towers are the heart of the crusher control center, designed for ease of use and maximum efficiency. These towers can be mounted inside power vans or on pull trailers, allowing them to be towed by a pickup truck. Raised and lowered using a 12-volt hydraulic scissor lift, they are securely pin-locked within the tower mounting frame once in the operating position.

Designed with health and safety in mind, these towers feature an optional positive pressurized cabin to minimize exposure to dust, silica, and other environmental contaminants. Noise reduction elements inside the tower enhance operator comfort, while interior and exterior lighting provide improved visibility. Climate control and roll-down see-through blinds allow for all-weather operation, and rear access through a full glass door and an aluminum floor hatch (pop-up) offers a quick and easy escape route.

The standard 6' x 10' tower is equipped with a 62" front window, a 48" tempered glass rear access door, and large sliding side windows, providing operators with an unobstructed, unparalleled view from the fully adjustable captain's chair. With state-of-the-art interior climate control, ELRUS Control Towers ensure year-round operator comfort. They also include bronze-tinted laminated safety glass, acoustical foam interiors with 1 ½" insulation, heavy-duty rubber flooring, and stainless-steel kickboards for durability and safety.

The towers are available in two configurations: Pop-Up Towers designed to be mounted inside control vans, and stationary models that can be mounted on tandem axle tow trailers or placed in various positions for optimal site management.

# POP-UP TOWERS MOUNTED ON PULL TRAILERS



Our hydraulic raise-and-lower Pop-Up Control Towers can be mounted on pull trailers or inside Power Vans, towable by a pickup truck. Designed with health and safety in mind, these towers provide operators with a secure, enclosed environment without requiring additional space for MCC, generator sets, or storage.

As the heart of the crusher control center, they are raised and lowered using a 12-volt hydraulic scissor lift and are securely pin-locked within the tower mounting frame, making them an ideal solution for both portable and permanent plant operations.

## FEATURES:

- 30" locking steel door with an 18" window
- Full 360° view of the crushing spread
- Climate control for year-round operator comfort
- Ample space for control panels, phones, computer controls, etc.
- Pre-wired for lights, air conditioning, heat, and other accessories
- Pop-Up Tower are available in the following sizes: 6' x 8', 6' x 10'

## Optional Awning Package

- Provides additional protection from the sun
- Fold-down and lockable for added security

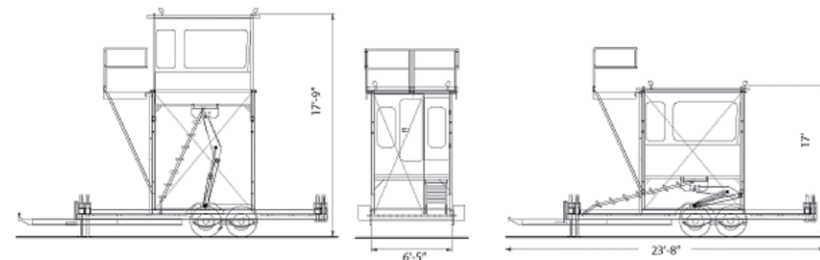

# STATIONARY CONTROL TOWERS



## FEATURES:

- 30" locking steel door with an 18" window
- Full 360° view of the crushing spread
- Climate control for operator comfort, ensuring year-round usability
- Ample space for control panels, phones, computer controls, etc.
- Pre-wired for lights, air conditioning, heat, and other necessary accessories
- Stationary Control Towers are available in the following sizes:
  - 6' x 8'
  - 6' x 10'
  - 6' x 12'
  - 8' x 10'
  - 10' x 14' (optional awning package is available for the 10' x 14' model)

## Optional Awning Package

- Provides additional protection from the sun
- Fold-down and lockable for added security





# PARTS AND SERVICE

ELRUS offers a full range of parts and consumables, supported by a team of experts ready to get your equipment back to peak performance. Our skilled service specialists provide 24/7 support, on-site repairs, and rebuilds, ensuring you stay up and running wherever you are.



 | [ELRUSAggregateSystems](#)    | [ELRUSAggregateSystems](#)    | [ELRUSAggregateSystems](#)    | [ELRUSAggregateSystems](#)

## ELRUS AGGREGATE SYSTEMS

### HEAD OFFICE:

4409 Glenmore Trail, SE  
Calgary AB T2C 2R8  
(403) 279-7741 1-888-535-7877

### NISKU, AB

1302 10 Street  
Nisku, AB  
T9E 8K2  
(780) 980-5600

### SASKATOON, SK

#100-737 66 Street  
Saskatoon, SK  
S7P 0E4  
(306) 668-0890

### WINNIPEG, MB

67007 Sturgeon  
Road 8 E, Rosser, MB  
R4B 0B2  
(204) 888-5588

### CAMBRIDGE, ON

170 Turnbull Court  
Cambridge, ON  
N1T 1J2  
(519) 624-6500

### AYLMER, ON

702 Talbot Street  
West Aylmer, ON  
N5H 2V1  
(226) 777-8668

### CHEHALIS, WA

173 N Hamilton Rd,  
Chehalis, WA 98532  
United States  
(253) 891-0888